



HILLS INC.

7785 Ellis Rd.

W. Melbourne, FL 32904

U.S.A

PHONE: (321) 724-2370

FAX: (321) 676-7635

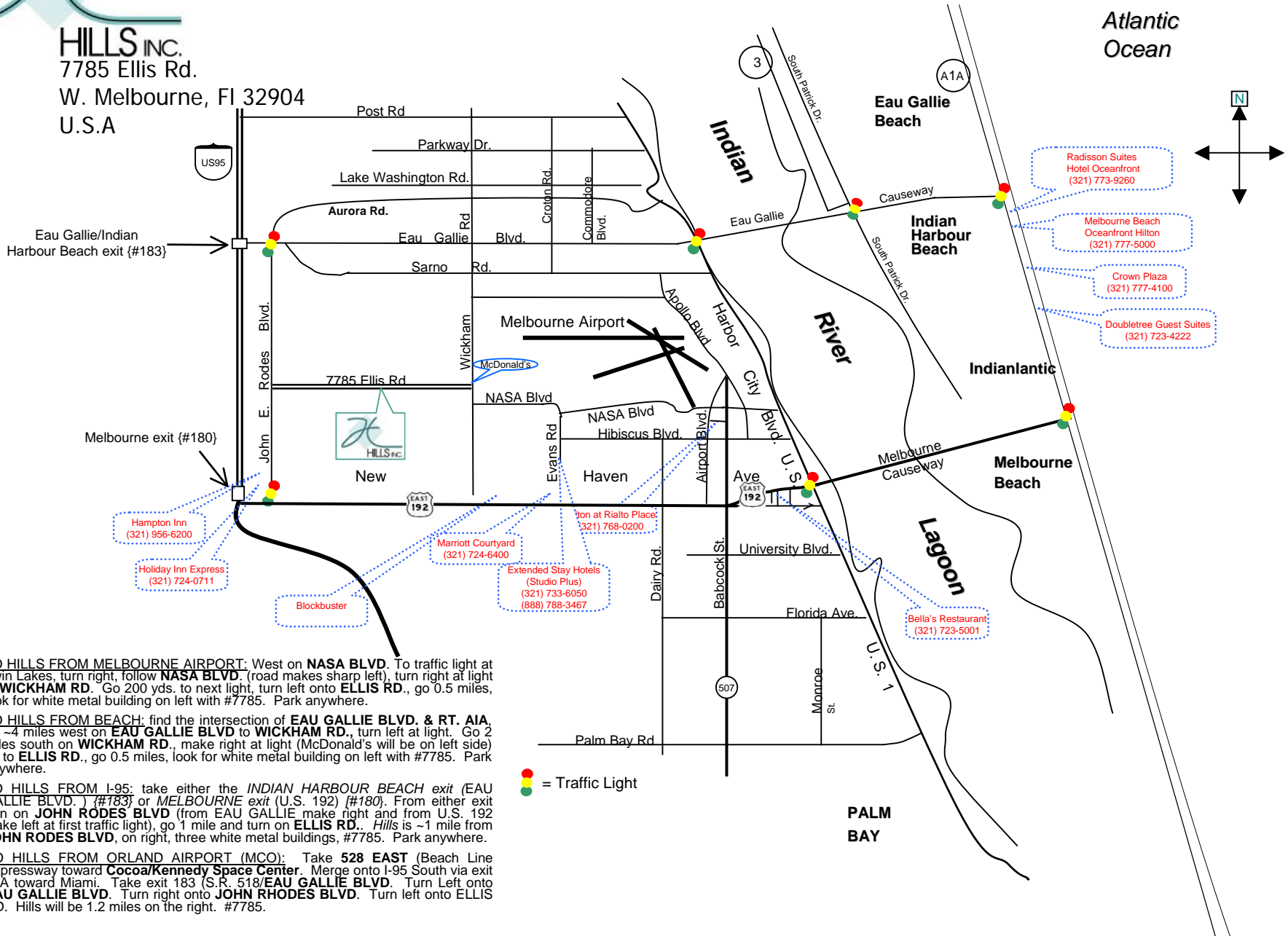

TO HILLS FROM MELBOURNE AIRPORT: West on **NASA BLVD.** To traffic light at Twin Lakes, turn right, follow **NASA BLVD.** (road makes sharp left), turn right at light at **WICKHAM RD.** Go 200 yds. to next light, turn left onto **ELLIS RD.**, go 0.5 miles, look for white metal building on left with #7785. Park anywhere.

TO HILLS FROM BEACH: find the intersection of **EAU GALLIE BLVD. & RT. A1A**, go ~4 miles west on **EAU GALLIE BLVD.** to **WICKHAM RD.**, turn left at light. Go 2 miles south on **WICKHAM RD.**, make right at light (McDonald's will be on left side) on to **ELLIS RD.**, go 0.5 miles, look for white metal building on left with #7785. Park anywhere.

TO HILLS FROM I-95: take either the **INDIAN HARBOUR BEACH** exit (EAU GALLIE BLVD.) (#183) or **MELBOURNE** exit (U.S. 192) (#180). From either exit turn on **JOHN RODES BLVD** (from EAU GALLIE make right and from U.S. 192 make left at first traffic light), go 1 mile and turn on **ELLIS RD.** Hills is ~1 mile from **JOHN RODES BLVD**, on right, three white metal buildings, #7785. Park anywhere.

TO HILLS FROM ORLAND AIRPORT (MCO): Take **528 EAST** (Beach Line Expressway toward **Cocoa/Kennedy Space Center**). Merge onto I-95 South via exit 42A toward Miami. Take exit 183 (S.R. 518/**EAU GALLIE BLVD.**). Turn Left onto **EAU GALLIE BLVD.** Turn right onto **JOHN RODES BLVD.** Turn left onto **ELLIS RD.** Hills will be 1.2 miles on the right. #7785.